

# Open-Frame OLED Signage - 55EF5C

Custom displays designed to be arched, curved, concave or convex.

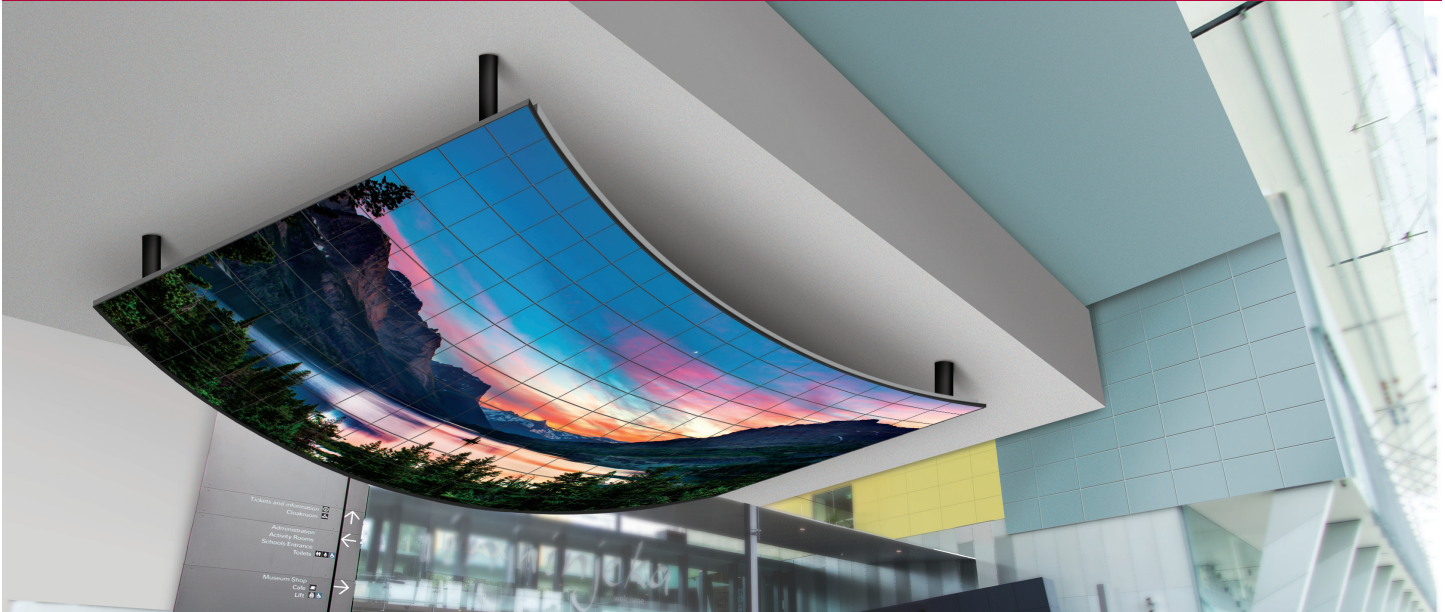

Images on screen are simulated

Because the 55EF5C is an open-frame curved signage, it can be used in a variety of sizes and shapes in many different spaces due to its expandable nature and curved format. Your 55EF5C configuration will add impact to virtually any space, becoming an instant landmark for you and your customers. Because it is an IPS panel, the visibility and image quality will remain consistent, regardless of the viewing angle. The 55EF5C is available for purchase in quantities of 2 or 3 panels, allowing for flexibility in how it can be configured and mounted\*.

\*Please note that all product specifications represent a single panel.

## Why OLED Technology?



### Perfect Black

#### Limitless contrast and deepest black

Self-lighting pixels switch off completely to reproduce black. No light bleeding. Absolute black offers infinite contrast.



LCD

LG OLED Signage



### Perfect Color

#### Accurate & stable color reproduction

Self-lighting pixels bring colors to life with superb accuracy.

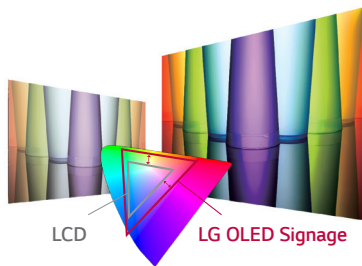

LCD

LG OLED Signage



### Perfect Viewing Screen

#### Wide viewing angle

LG OLED Signage delivers awe-inspiring picture quality across the entire screen, even from wide viewing angles.



LCD

LG OLED Signage



### Crisp, Clear Motion

#### Faster response time

LG OLED Signage provides a 5,000-times faster motion-picture response time, for perfectly clear images without blurring.



LCD

LG OLED Signage



### Perfect Design

#### Slim and light

With just two layers, the LG OLED Signage display is unbelievably lightweight and thin.

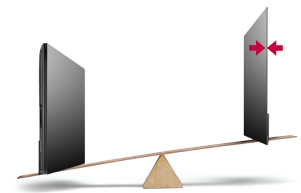

LCD

VS LG OLED Signage

# Open-Frame OLED Signage - 55EF5C

Custom displays designed to be arched, curved, concave or convex.



**Screen Size**  
55"  
(54.64" Diag)

## The 411 on OLED

- OLED: Organic Light Emitting Diode
- OLED displays use self-lighting pixels for exact control of image brightness and quality.
- With no separate light source and only half the layers of an LCD panel, OLED displays are extremely thin and lightweight.



Images on screen are simulated

## Key Features

### Artistic Display that Becomes a Landmark

The curved design provides outstanding space efficiency, while also enabling flexible mounting and positioning. When you mount a 55EF5C configuration, you instantly make an impact and command attention.



### Space-fitting Design Option

Extendable and curved



In Landscape

Max Curvature in Landscape : ~2,000R  
• Radius: 2,000 mm  
• Circumference: 12,560 mm



In Portrait

Max Curvature in Portrait : ~1,500R  
• Radius: 1,500 mm  
• Circumference: 9,420 mm

What is R?



### Components & Model Codes

OLED Module & Signage Box & T-Con Box & Cables

- 2 ea (55EF5C-M2)
- 3 ea (55EF5C-M3)
- Accessory 1: A1\*\*\*\*\*EF5C
- Accessory 2: A2\*\*\*\*\*EF5C

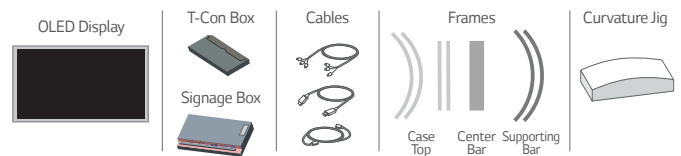

### Field-assembly Process

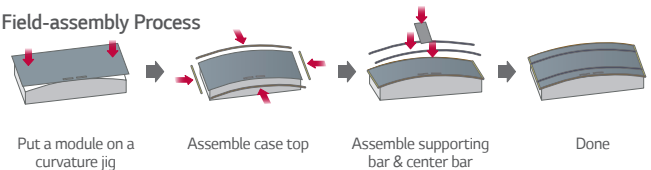

# Open-Frame OLED Signage - 55EF5C

Custom displays designed to be arched, curved, concave or convex.

## Specifications

(For single 55EF5C Panel)

|                            |                                  | 55EF5C  |  |
|----------------------------|----------------------------------|---|--|
| PANEL                      | Screen Size                      | 55"   |  |
|                            | Panel Technology                 | OLED  |  |
|                            | Aspect Ratio                     | 16:9  |  |
|                            | Native Resolution                | 1,920 x 1,080 (FHD)   |  |
|                            | Brightness                       | 100/400 cd/m <sup>2</sup> (APL 100%/25%) *Average Picture Level   |  |
|                            | Viewing Angle (H x V)            | 178 x 178   |  |
|                            | Response Time                    | 1 ms (G to G), 8 ms (MPRT)  |  |
|                            | Surface Treatment                | Hard coating (2H), Anti-reflection treatment of the front polarizer (Reflectance Typ. 1.0%)   |  |
|                            | Operation Hours                  | 18 hrs/7 days (Moving video only)   |  |
|                            | Orientation                      | Portrait & Landscape  |  |
| CONNECTIVITY               | Input                            | HDMI, DP  |  |
|                            | Output                           | DP, Audio   |  |
|                            | External Control                 | RS232C in/out, RJ45 in, IR receiver, LAN out, IR out, USB   |  |
|                            | Bezel Color                      | Black   |  |
|                            | Bezel Width                      | 7.2, 7.2, 7.2, 7.2 mm (U, B, L, R *Off-bezel)   |  |
| PHYSICAL SPECIFICATION     | Dimension (W x H x D)            | <b>Head</b><br>1. Landscape (W x H)<br>- 2,000R, Concave: 47.8" x 27.7" (1,213.7mm x 704.1mm)<br>- 2,000R, Convex: 47.8" x 27.7" (1,214.2mm x 704.1mm)<br>- 3,000R, In-curve: 48.2" x 27.7" (1,223.1mm x 704.1mm)<br>- 4,000R, Out-curve: 48.3" x 27.7" (1,226.2mm x 704.1mm)<br>- 4,500R, Out-curve: 48.3" x 27.7" (1,227.0mm x 704.1mm)<br>- 5,000R, In-curve: 48.3" x 27.7" (1,227.5mm x 704.1mm)<br>- 5,000R, Out-curve: 48.3" x 27.7" (1,227.5mm x 704.1mm)<br>- 8,000R, In-curve: 48.4" x 27.7" (1,228.8mm x 704.1mm)<br>2. Portrait (W x H)<br>- 1,500R, Concave: 48.4" x 27.6" (1,229mm x 700.7mm)<br>- 1,500R, Convex: 48.4" x 27.6" (1,229mm x 701.2mm)<br>3. Landscape/Portrait (D) - not affected by orientation/curvature<br>- Module Only: 0.8" (21.4mm) (Incl. case top)<br>- Module + Center Bar: 1.2" (30mm)<br>- Module + Center Bar + T-Con Box: 1.6" (41.2mm)<br>- Module + Center Bar + T-Con Box + Signage Box: 3.6" (91.2mm)<br><b>T-Con Box</b> 12.3" x 8.4" x 0.6" (312.2mm x 213.4mm x 16mm)<br><b>Signage Box</b> 16.2" x 8.8" x 2.5" (412.6mm x 222.4mm x 64.3mm) |  |
|                            |                                  | Weight  | Head: 24.2 lbs (11 kg), T-CON Box: 3.3 lbs (1.5 kg), Signage Box: 10.1 lbs (4.6 kg)  |
|                            |                                  | Carton Dimensions (W x H x D)   | 53.9" x 37" x 14" (1,370mm x 940mm x 355mm)  |
|                            |                                  | Packed Weight   | 154.8 lbs (70.2 kg) (Panel 3 ea, T-CON Box 3 ea, Signage Box 3 ea)   |
|                            |                                  |   | Temperature Sensor, Tile mode, Cooling FAN, DPM Select, Energy Saving, Motion Eyecare, File Play with USB, PIP/PBP, Internal Memory (64 GB), USB Cloning, DP Daisy Chain, Wake on LAN, PM Mode, Contents Scheduling, Local Time Auto Setting, Failover |
| SPECIAL FEATURES           |                                  |   |  |
| ENVIRONMENT CONDITIONS     | Operation Temperature            | 32°F to 104°F (0°C to 40°C)   |  |
|                            | Operation Humidity               | 10% to 80%  |  |
| POWER                      | Power Supply                     | 100-240 V-, 50/60 Hz  |  |
|                            | Power Type                       | Built-in Power  |  |
| POWER CONSUMPTION          | Typ.                             | 190W  |  |
|                            | DPM                              | 3W Under  |  |
|                            | Power Off                        | 0.5W Under  |  |
| STANDARD (CERTIFICATION)   | Safety                           | UL/cUL/CB/TUV/KC  |  |
|                            | EMC                              | FCC Class "A"/CE/KCC  |  |
|                            | ErP/Energy Star                  | Yes/NA  |  |
| MEDIA PLAYER COMPATIBILITY | OPS-Type Compatible              | Yes   |  |
|                            | External Media Player Attachable | Yes   |  |
| SOFTWARE COMPATIBILITY     | SuperSign OLED                   | Yes   |  |
|                            | SuperSign C                      | Yes   |  |
| ACCESSORIES                | Basic                            | Remote Controller (including battery 2 ea), Power Cord, QSG, Mini HDMI Cable (3M x 2 ea, for connection between head and signage box), Power Harness Cable (3M x 2 ea, for connection between head and signage box), Regulation Book, Phone to RS232C Gender, Jack Cover, Signage Box Mounting Bracket  |  |
| OTHER                      | UPC                              | 7 19192 60880 1 (55EF5C-M2)   7 19192 60881 8 (55EF5C-M3)   |  |
|                            | Warranty                         | 3-Year Limited Warranty (Parts and Labor)   Extended Warranties Available   |  |

Download LG Commercial Display Mobile App



Learn more [www.lg.com/b2b](http://www.lg.com/b2b) or [lgsolutions.com](http://lgsolutions.com)

**YouTube** [youtube.com/c/LGCommercialDisplay](https://youtube.com/c/LGCommercialDisplay)

LG may make changes to specifications and product descriptions without notice.  
 Copyright © 2017 LG Electronics Inc. All rights reserved. "LG Life's Good" is a registered trademark of LG Corp.  
 The names of products and brands mentioned here may be the trademarks of their respective owners.  
 SPEC\_55EF5C\_121622\_PR