

Technical data

Maximum load capacity	100KG
Height Range	1080-1820mm
Applicable Dimensions for TV	32"-100"



Accessory list

Attention: The drawings below are only for reference which might be slightly different from the actual object, please in kind prevail. Any tools missing or installation problems, please contact the customer service firstly.

No.	Image	Spec	Qty
A		M4x12mm	2
B		M6x25mm	4
C		M8x25mm	4
D		M8x16&M8X36	4+4
E		Stuck Metal Sheet	4
F		Magnetic Level	1
G		Gasket	4
H		Washer	4+4

Component list

1. Product (Electric Collaborative Media Wall) (x1)
2. Top cover (x1)
3. Storage box (x2)
4. TV panel (x1)
5. TV plate (x2)
6. Rotary Knob (x2)

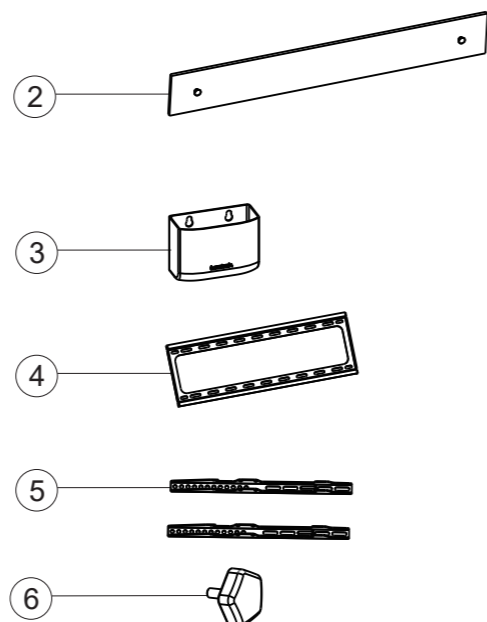
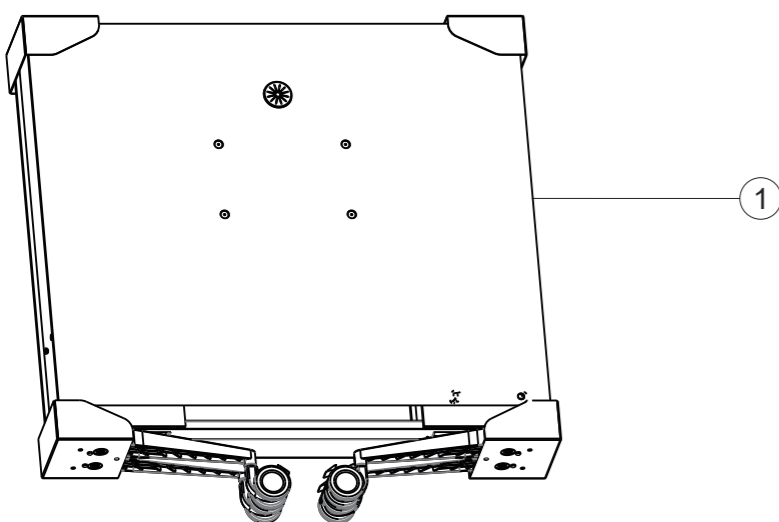

STEP 1

Removal of corner guards on both sides of the foot of packaging.

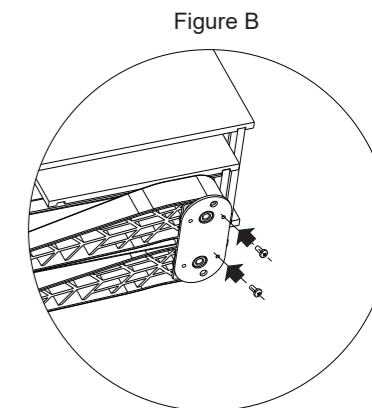
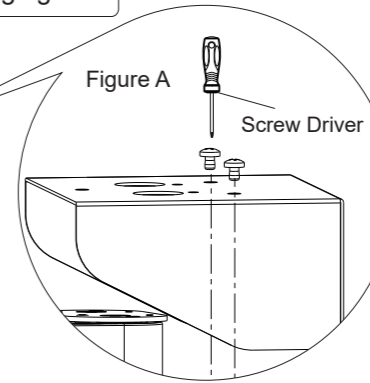
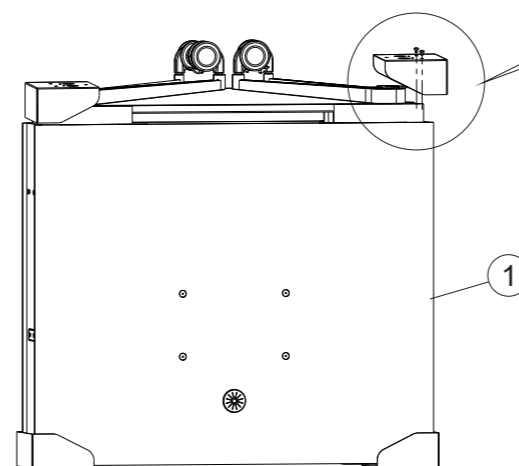

Put the product up side down. Remove the corner guards on both sides of the bottom foot of the product with a screwdriver (Fig. A). Then install the screw on the bottom foot on the threaded hole of sheet metal (Fig. B).

STEP 2

Open up the legs

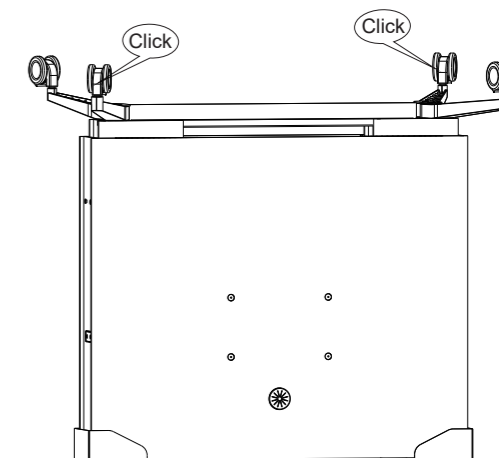
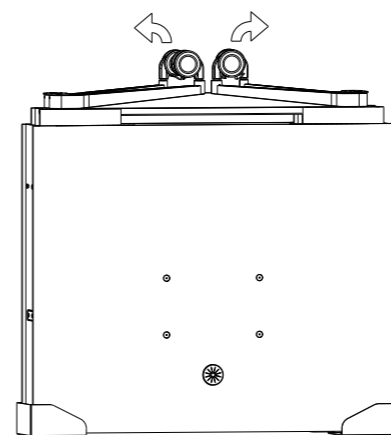

Open up the legs according to the directions shown on the picture, and when you hear "Pah" the foot seating is finished.

STEP 3

Remove top metal plate and then install top covers

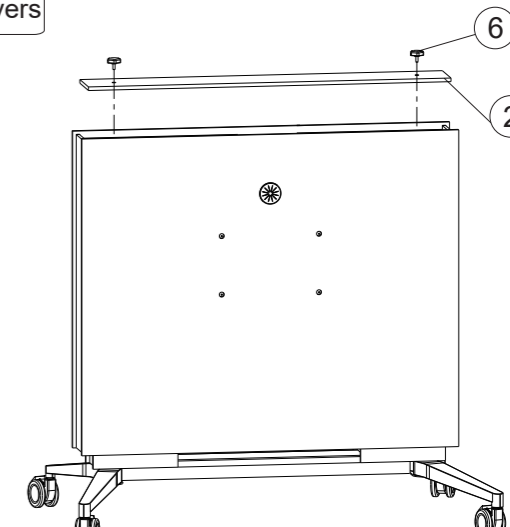
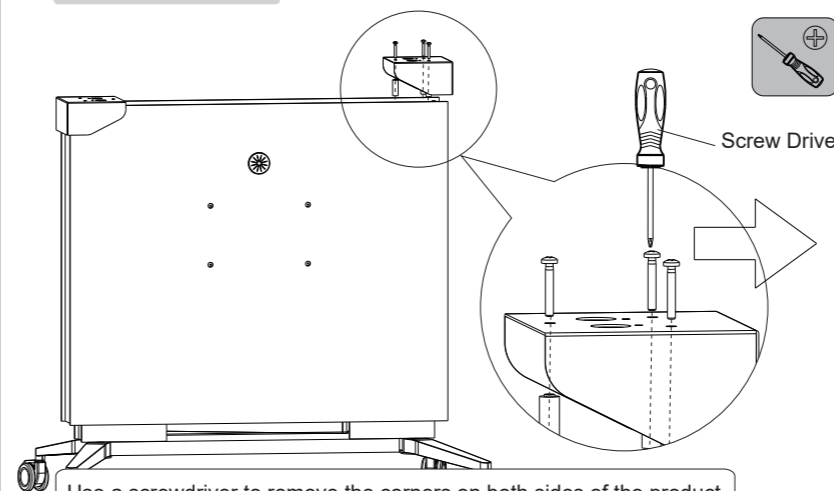

Use a screwdriver to remove the corners on both sides of the product. The removed parts are no longer used.

Install top shield plate with rotary knob.

STEP 4

Remove orifice plug and install storage box

Firstly, install the storage box on the axle, then press it down slightly.

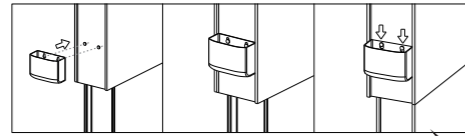

Control Panel

3

First attach the thumb screw (A) to the threaded hole of the plug and then pull it together.

A x2

After connecting the product's power plug to an external power source, raise the product to the appropriate height with the control panel. Then remove the four holes on the front panel by hand-tightening the screws (A). Remove the storage box from the package and secure it to the left and right sides of the product through the reserved hanging shaft as shown.

STEP 7

Connecting cables

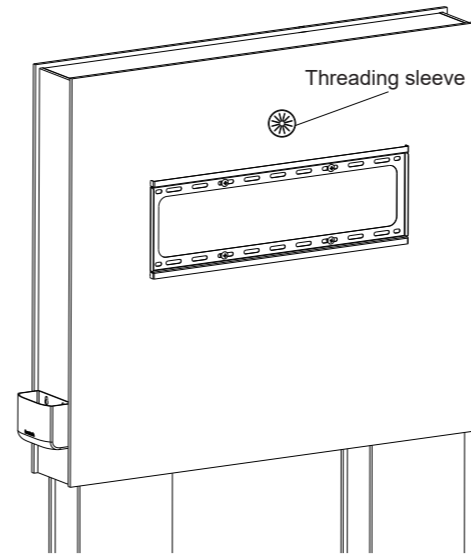

Threading sleeve

Power line

Television

Insert the power cord of the TV into the threading sleeve

STEP 5

Install TV panel

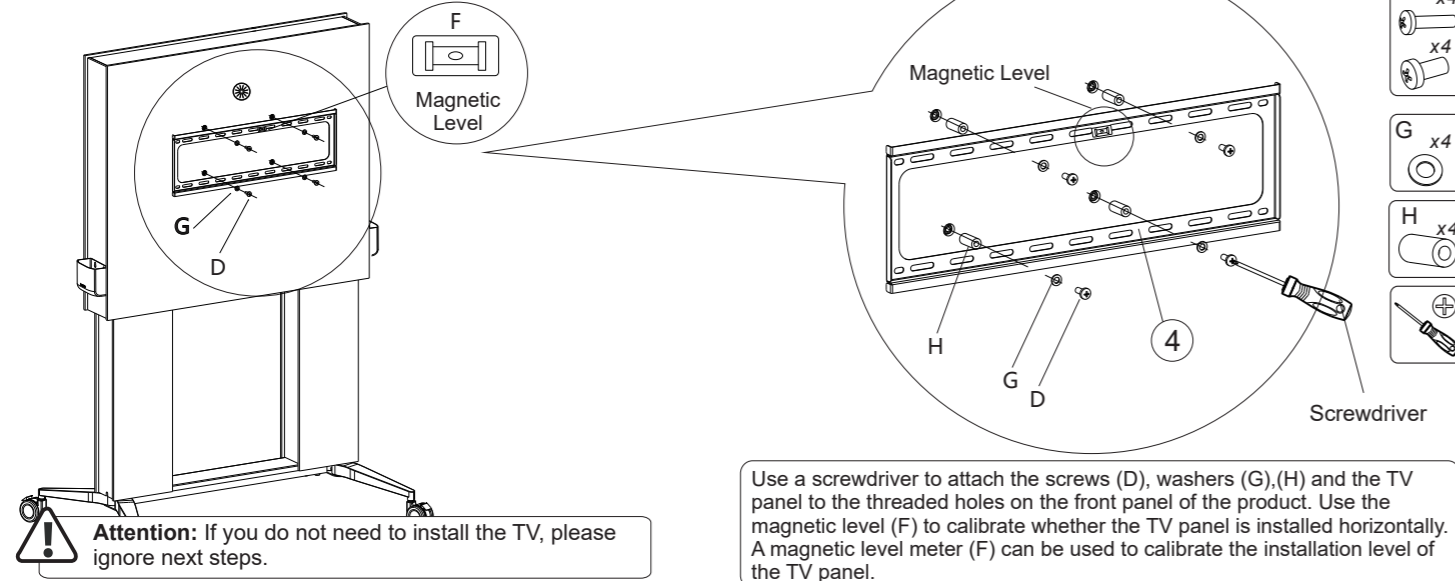

F
Magnetic Level

Magnetic Level

D x4
x4
G x4
H x4

Screwdriver

Use a screwdriver to attach the screws (D), washers (G),(H) and the TV panel to the threaded holes on the front panel of the product. Use the magnetic level (F) to calibrate whether the TV panel is installed horizontally. A magnetic level meter (F) can be used to calibrate the installation level of the TV panel.

Attention: If you do not need to install the TV, please ignore next steps.

STEP 8

Hanging the TV

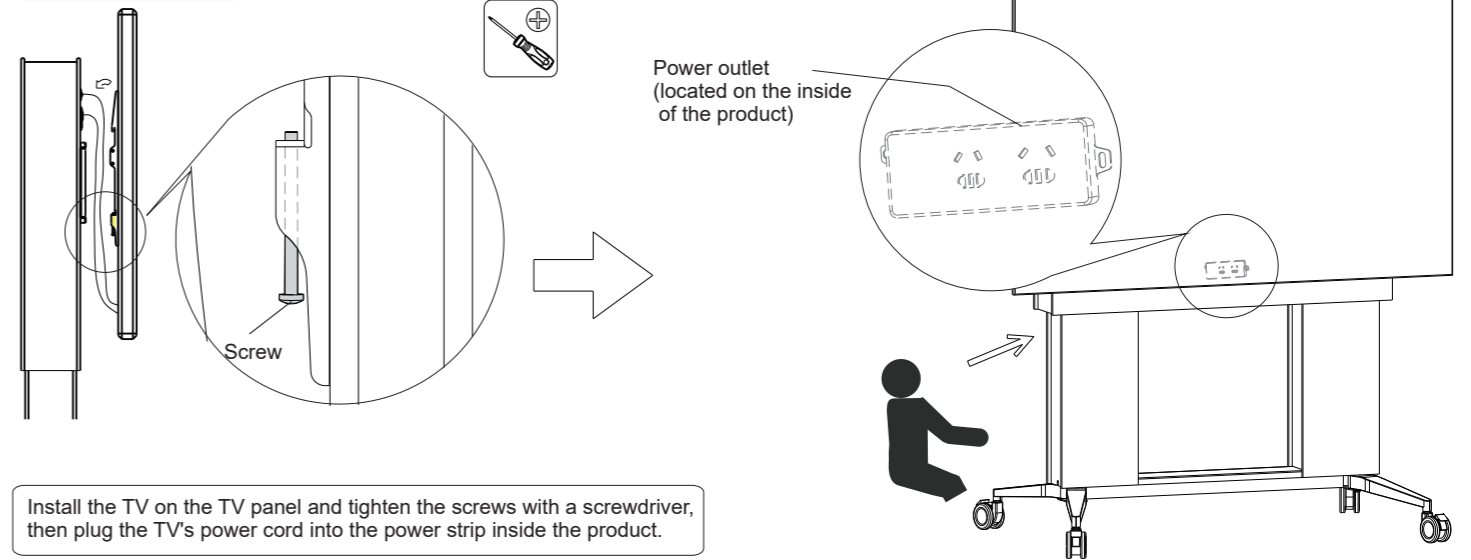

Install the TV on the TV panel and tighten the screws with a screwdriver, then plug the TV's power cord into the power strip inside the product.

Power outlet
(located on the inside
of the product)

STEP 6

Connect the TV to the TV plate

B x4 C x4 E x4 H x4

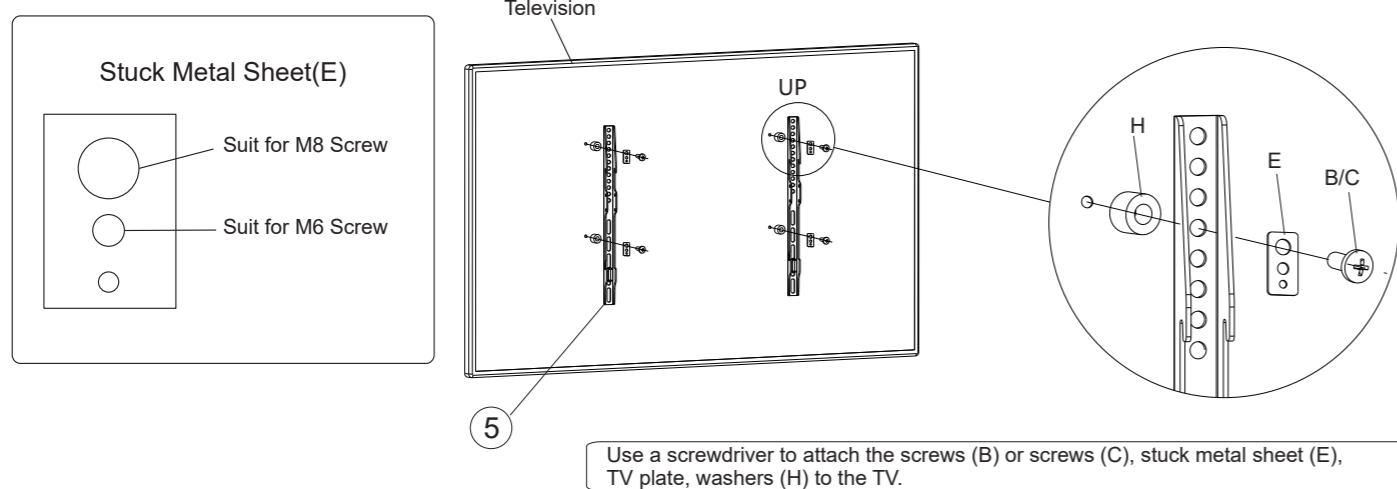

Stuck Metal Sheet(E)

Suit for M8 Screw

Suit for M6 Screw

Television

UP

5

Use a screwdriver to attach the screws (B) or screws (C), stuck metal sheet (E), TV plate, washers (H) to the TV.

Common fault treatment

The following tips will help you detected and eliminate the common fault and error.If the fault you met is not listed below, please contact with your supplier. Only themanufacturer and professionals are capable for investigating and correcting those fault and error.

Fault phenomenon	Method
No response while long pressing down arrow after connected with a power supply	1.Check if all the cables be connected well 2.Contact your supplier or dealer
No response while pressing up arrow/ down arrow after connected with a power supply	1.Check if all the cables be connected well 2.Contact your supplier or dealer
Rising in a low speed	1. Check if overloaded, max loading: 125kg; 2. Contact your supplier or dealer
The motor not move as instructed	1. Contact your supplier or dealer
Go down but not go up	1.Reposition 2.Contact your supplier or dealer
Downward sliding	1. Check if overloaded, max loading: 125kg; 2. Contact your supplier or dealer
Frequently Reposition	1. Check if overloaded, max loading: 125kg; 2. Contact your supplier or dealer
Overwork (Duty cycle: Max 2min on/18min OFF)	1. Restart after suspend for 18mins while connecting with power; 2. Contact your supplier or dealer;



Attention

1. Power supply: AC100V-240V,50/60Hz
2. Service Environment: 0-40°C
3. Unplug the power plug before cleaning, wipe the dust on surface with slight wet dishcloth when cleaning, be careful not to let the drops into the internal parts, not loose the connector.
4. The electric box contains electronic components, metals, plastics, wires etc., so dispose of it in accordance with each country's environmental legislation, not the general household waste.
5. Check carefully to ensure correct and complete assembly before using.
6. Be familiar with all functions and program settings of the product before first use.
7. Children are forbidden to play on the product because of unforeseen action when playing, so any dangerous consequences caused by this improper action will not be on
8. Slight noise caused by the V-ribbed belt or brake system due to structure will not have any effect on the use of the equipment.
9. Corrosive or abrasive materials are forbidden to clean the equipment. Must ensure that the cleaner used will not pollute the environment.
10. This appliance can be used by children aged from 8 years and above and persons with reduced physical, sensory or mental capabilities or lack of experience and knowledge if they have been given supervision or instruction concerning use of the appliance in a safe way and understand the hazards involved. Children shall not play with the appliance.
11. Cleaning and user maintenance shall not be made by children without supervision.
12. If the supply cord is damaged, it must be replaced by the manufacturer, its service agent or a similarly qualified person in order to avoid a hazard.
13. Please make sure there is no hazard sources in your operating environment. e.g., do not litter the tools around. Always be careful to treat the packaging materials in order to avoid any possible danger, e.g. plastic bag may lead to choking hazard to children.
14. Keep the original package of the equipment if necessary in case of the future use in transportation.
15. Make sure you have read the instructions before installation and fully understand how to install them. If you do not understand any of the installation steps, please contact the professional installer.
16. Please wear safety clothing and matching tools when installing. At least two people should complete the installation together. If you do not wear safety clothing, it may cause damage to the human body, serious injury or death.
17. Please check the connecting parts every two months to check if the screws are loose.
18. Before installation, please make sure to check the load capacity. Never exceed the maximum load of 100Kg (the weight of the TV bracket does not exceed 100Kg), otherwise it will cause damage to the product or personal injury.
19. Note: These products are for indoor use only. If used outdoors, it may cause damage to the product or personal injury.

EU/EG - Declaration of conformity

Manufacturer: celexon Europe GmbH & Co. KG

Address: Gutenbergstrasse 2, 48282 Emsdetten, DE

hereby declares that the following product bearing the celexon trademark

Productname: Professional electric height adjustable Display-Trolley Adjust-32100MW - 74cm
Professional electric height adjustable Display-Trolley Adjust-32100MB - 74cm

the basic provisions of the EU Directives listed below, in intended use in accordance with the instructions of the manufacturer the instructions given:

- EMC Directive 2014/30/EU
- Low Voltage Directive 2014/35/EU
- RoHS Directive 2011/65/EU

Comments:

The tests were carried out in normal mode and refer to the tested device and the specifically executed tests! This certificate relates exclusively to on the model of the device provided for testing.

A copy of the EU Declaration of Conformity can be found at <https://uk.celexon.com/certificates>.



The symbol indicates separate collection of electrical and electronic equipment in EU countries there. Please do not throw the device in the household waste. Find out about the regulations in your country valid take-back system and contact your local authority if you have questions about the disposal process or your local value and pollutant collection point.

Emsdetten, 8.12.2020

Christoph Hertz
Managing Director

